

SA 38 Specifications

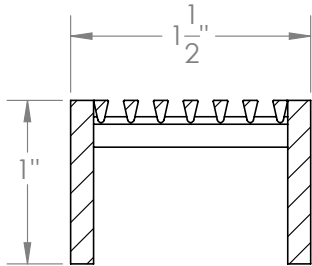

SA 38:

- Wedge wire grate for S-LAG 38
- 12 gauge 316L stainless steel
- 2mm wire, 2mm gap

Models (Overall dimension):

- SA 3836: 35-7/8" L x 1-1/2" W x 1" H
- SA 3848: 48-7/8" L x 1-1/2" W x 1" H
- SA 3860: 59-7/8" L x 1-1/2" W x 1" H
- SA 3872: 71-7/8" L x 1-1/2" W x 1" H

Finishes:

- Satin Stainless - SS
- Polished Stainless - PS
- Satin Bronze - SB
- Oil Rubbed Bronze - ORB
- Matte Black - BK



Infinity Drain
145 Dixon Avenue
Amityville, NY 11701
Phone: 516.767.6786
Fax: 516.740.3066
www.infinitydrain.com



NOTE: Installer must verify all rough-in dimensions prior to installation and consult local and national codes. Conformity and compliance to local and national codes are the responsibility of the installer.